

# TMP-US-5008-2

## The Missouri

A 3 meter tall climbing cube structure. Each cube is composed of 14 square and triangular sides. The cubes are hollow, and through the many openings, one can climb freely both from the inside and outside. At the top of the structure, the child can either descend through the slide or back down through the cubes.

Recycled HDPE: 

Steel: 



Crawling



Climbing



Sliding

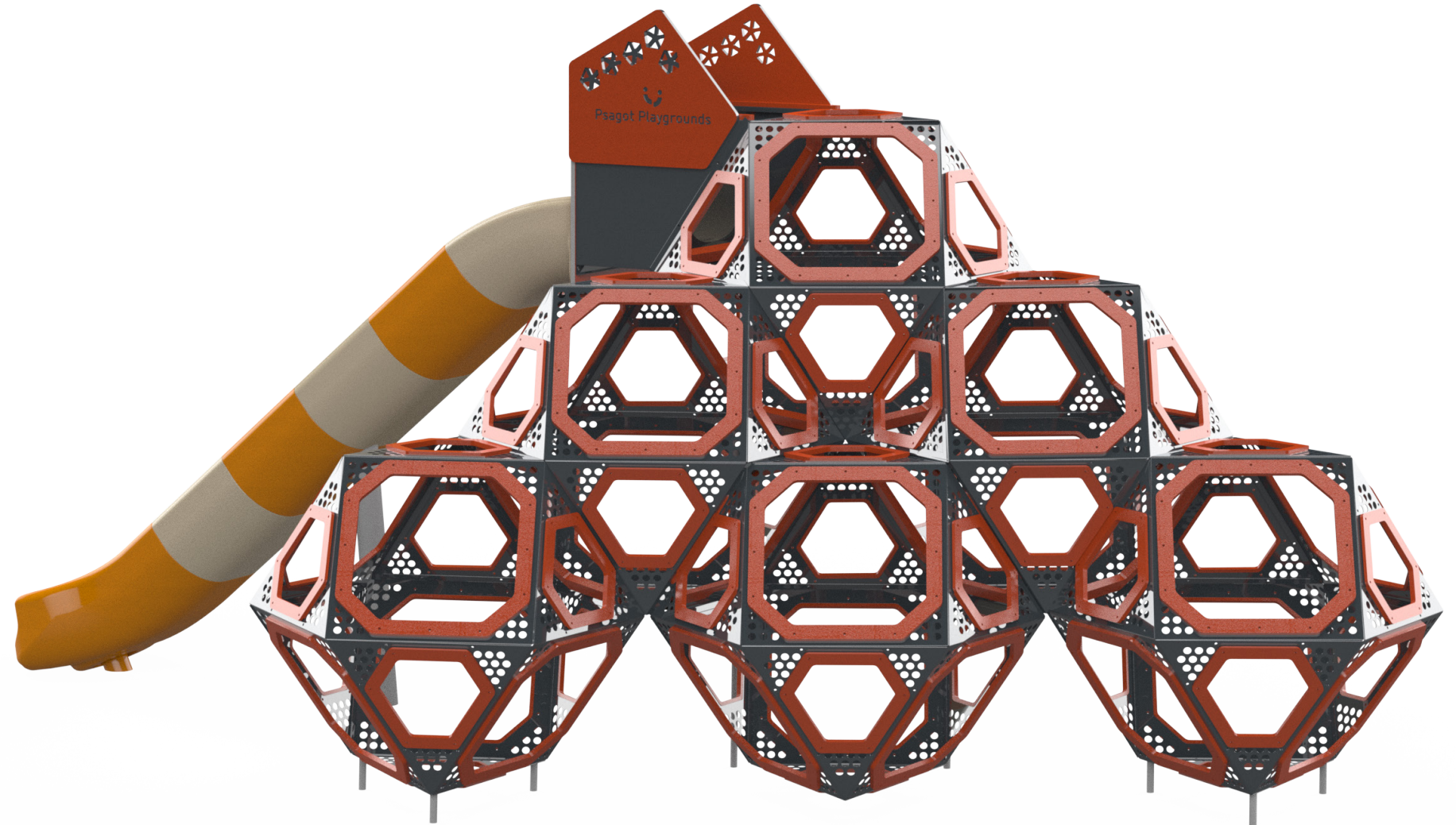

Ages 5-12



Users 48



L: 9'-2.6" W: 20'-2.3" H: 9'-7.2" | cm L: 288 W: 631 H: 300



Safety Zone 38'-1"/28'-10" | 503/1013 cm



Fall Height 7' | 220 cm



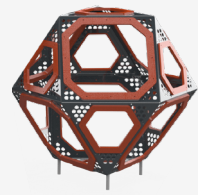

## Designed Climbing Element

The designed climbing element combines physical challenge with a unique and inviting design. Players develop physical skills such as strength, coordination, and balance while playing in a creative and designed environment. The unique design encourages players to play and explore, fostering their imagination and creativity.



## Slide

A slide is a fundamental and important element in any playground, considered one of the leading and most beloved attractions for players of all ages. The slide provides an enjoyable and exciting sliding experience that develops players' motor skills and coordination. Playing on the slide encourages movement, daring, and self-confidence.

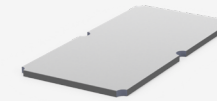

## Tread Surface

The tread surface provides support and safety during play on the structure. The surface is designed to prevent slipping and improve players' stability and security.

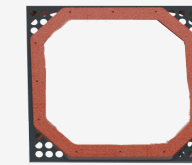

## Ventilated Panel

The ventilated panel offers an activity that stimulates the sense of touch and provides a feeling of wind and freshness. Playing with the panel develops players' motor and sensory skills.



## Steel

Steel structure that is strong and durable, oven-painted galvanized and coated with lead-free polyester powder for corrosion and rust resistance. The steel meets strict EN 1176 standards, ensuring high quality and safety. The steel is anti-vandalistic, requires minimal maintenance, and is fully recyclable. The high-quality paint ensures weather resistance and maintains a new appearance over time.



## Recycled HDPE

HDPE (High-Density Polyethylene) is a recycled material made from high-density polyethylene, produced from recycled materials that allows for further recycling. It excels in resistance to UV rays and wear and tear, making it particularly suitable for use in outdoor playground equipment. Its touch is smooth and pleasant, and its appearance is maintained over time. The advantages include high resistance to harsh weather conditions and environmental preservation. The material is capable of absorbing high energy, which helps prevent fractures.

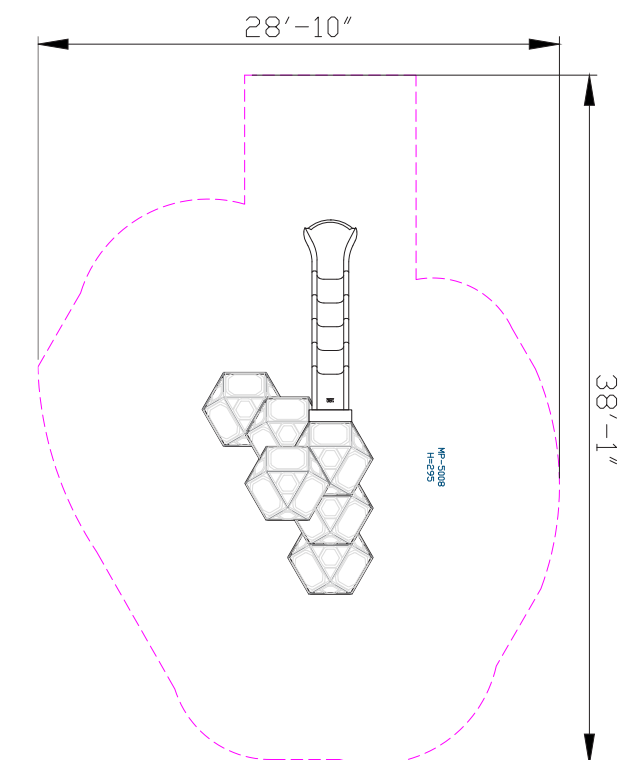
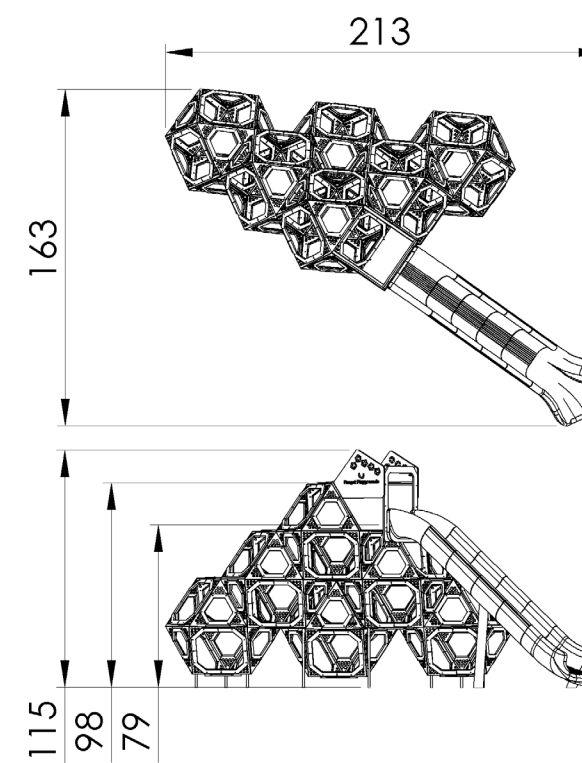

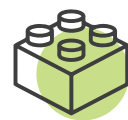
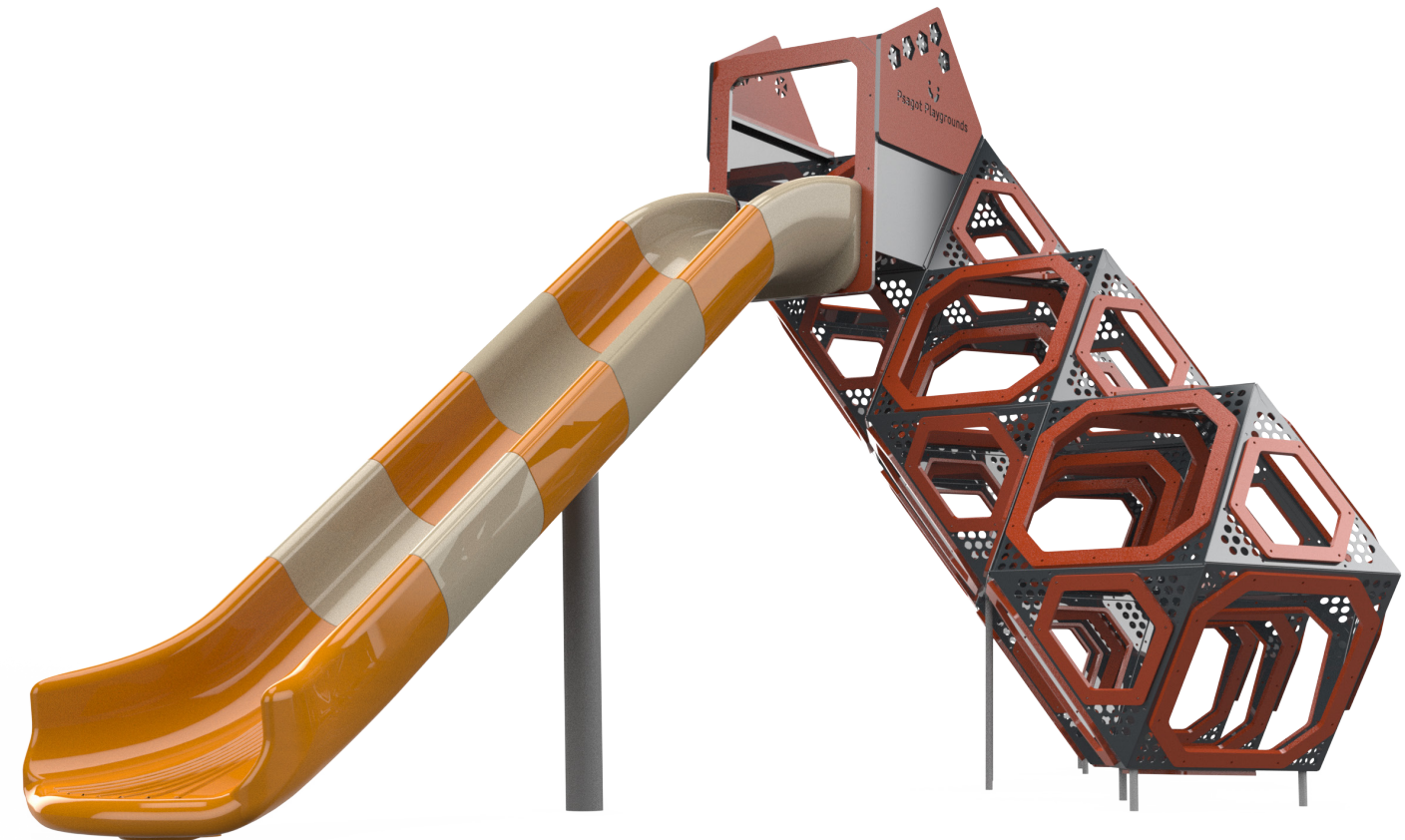
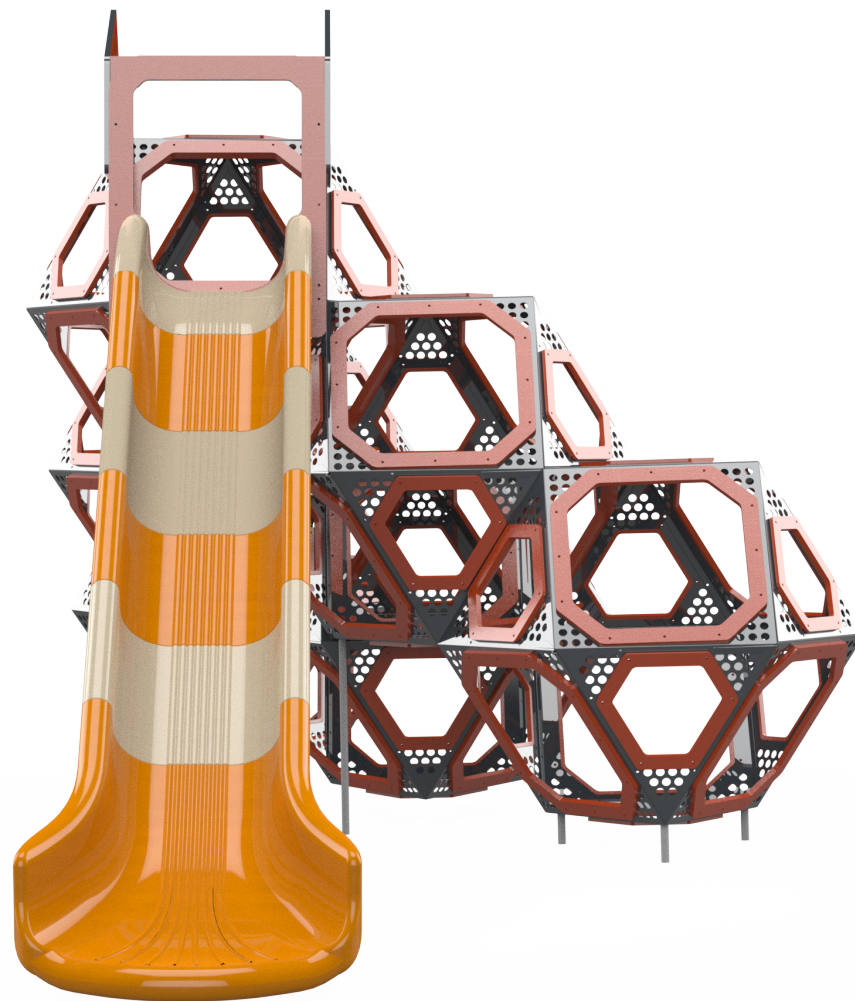

#### Motor Development

Foot-eye coordination - Improving coordination and balance through various equipment. Hand-eye coordination - Developing coordination and precision in activities requiring fine motor skills



#### Cognitive Development

Concentration- Developing the ability to focus and maintain attention in equipment requiring concentration. Creativity- Developing creative thinking and imagination in open and interactive play



#### Emotional Development

Imagination- Encouraging imagination and creating play worlds. Courage- Facing fears and new challenges. Confidence- Building self-confidence and belief in one's personal abilities. Independence- Developing independence and the ability to make personal decisions. Patience- Practicing patience and waiting for one's turn. Resilience- Coping with failure and trying again



#### Physical Development

Climbing - Strengthening arm and leg muscles, developing fitness and endurance